

ASS H 4.1.04 Rear vented capping - rear 'T' plate.

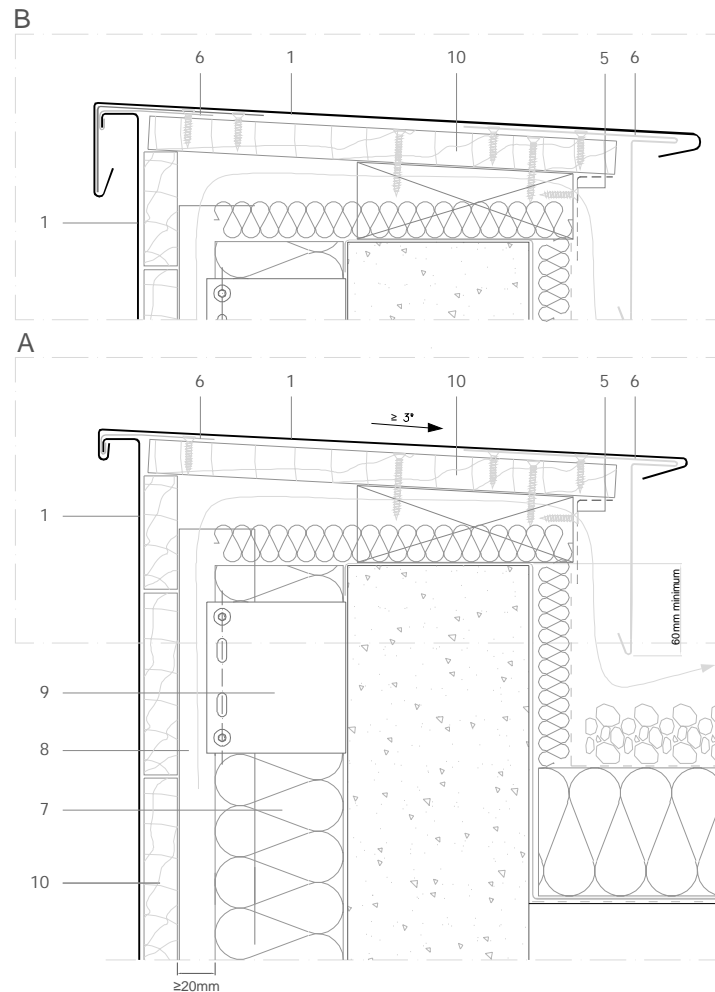

All dimensions are indicative unless specified on the drawing  
Sheet thickness may be exaggerated for clarity

Scale 1/5

Notes:

- 'A' shows the cladding head coping attached to the top standing seam, giving a very fine head to the façade.
  - 'B' shows the cladding head coping attached to a continuous galvanised fixing strip, allowing the front face of the coping to be increased if desired, to tie in with other cladding elements.
  - Generic structural details are given for indicative purposes only.
1. elZinc® cladding
  2. Membrane
  3. Structural underlay
  4. Folded galvanised steel profiles
  5. elZinc® perforated sheet
  6. elZinc® retention profile
  7. Insulation
  8. Wooden batten
  9. Wall bracket
  10. Substrate

ASS H 4.1.04 Rear vented capping - rear 'T' plate.

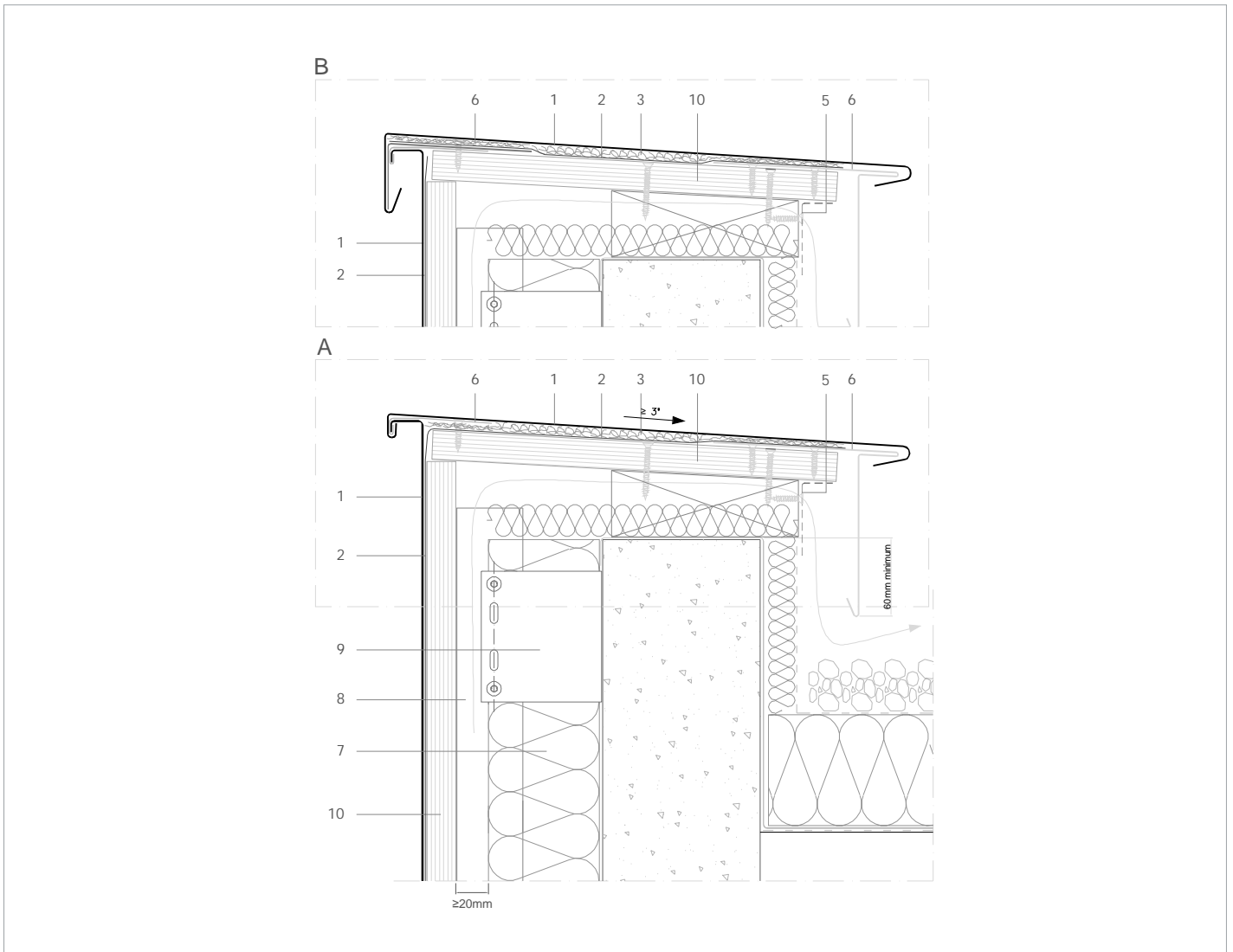

All dimensions are indicative unless specified on the drawing  
Sheet thickness may be exaggerated for clarity

Scale 1/5

Notes:

- 'A' shows the cladding head coping attached to the top standing seam, giving a very fine head to the façade.
  - 'B' shows the cladding head coping attached to a continuous galvanised fixing strip, allowing the front face of the coping to be increased if desired, to tie in with other cladding elements.
  - Generic structural details are given for indicative purposes only.
1. elZinc® cladding
  2. Membrane
  3. Structural underlay
  4. Folded galvanised steel profiles
  5. elZinc® perforated sheet
  6. elZinc® retention profile
  7. Insulation
  8. Wooden batten
  9. Wall bracket
  10. Substrate