

ASS H 4.1.05 Rear vented capping - rear downstand.

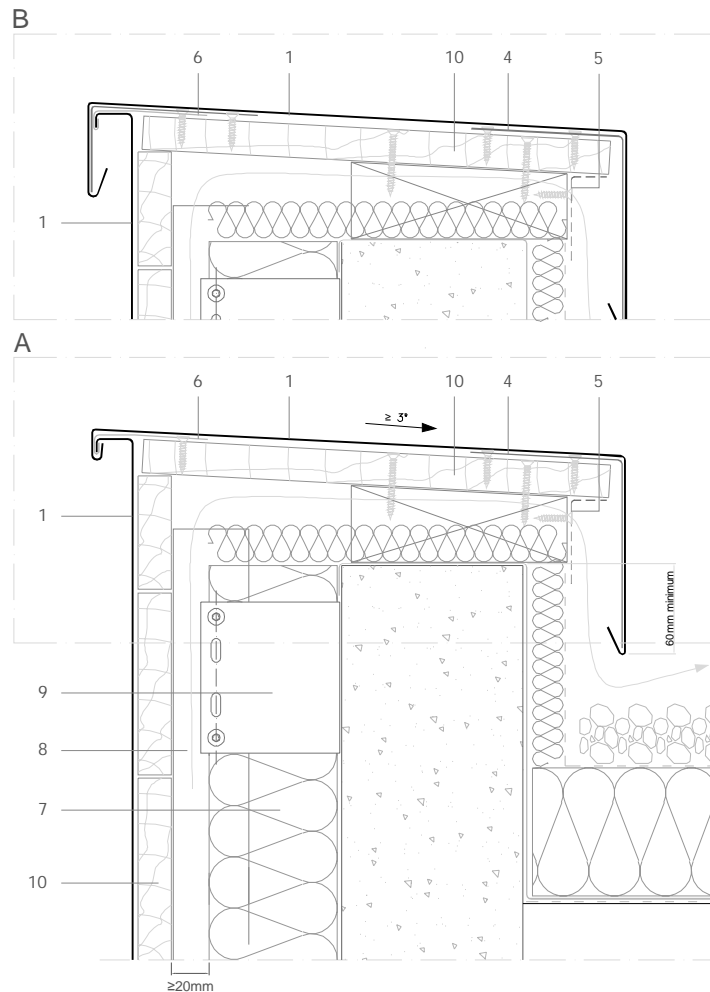

All dimensions are indicative unless specified on the drawing
Sheet thickness may be exaggerated for clarity

Scale 1/5

Notes:

- 'A' shows the wall capping folded around the top angle seam of the cladding, giving a very fine cladding head detail.
 - 'B' shows the wall capping folded around a continuous fixing strip to increase the vertical face of the capping to tie in visually with other cladding elements if desired.
 - Generic structural details are given for indicative purposes only.
1. elZinc® cladding
 2. Membrane
 3. Structural underlay
 4. Folded galvanised steel profiles
 5. elZinc® perforated sheet
 6. elZinc® retention profile
 7. Insulation
 8. Wooden batten
 9. Wall bracket
 10. Substrate

ASS H 4.1.05 Rear vented capping - rear downstand.

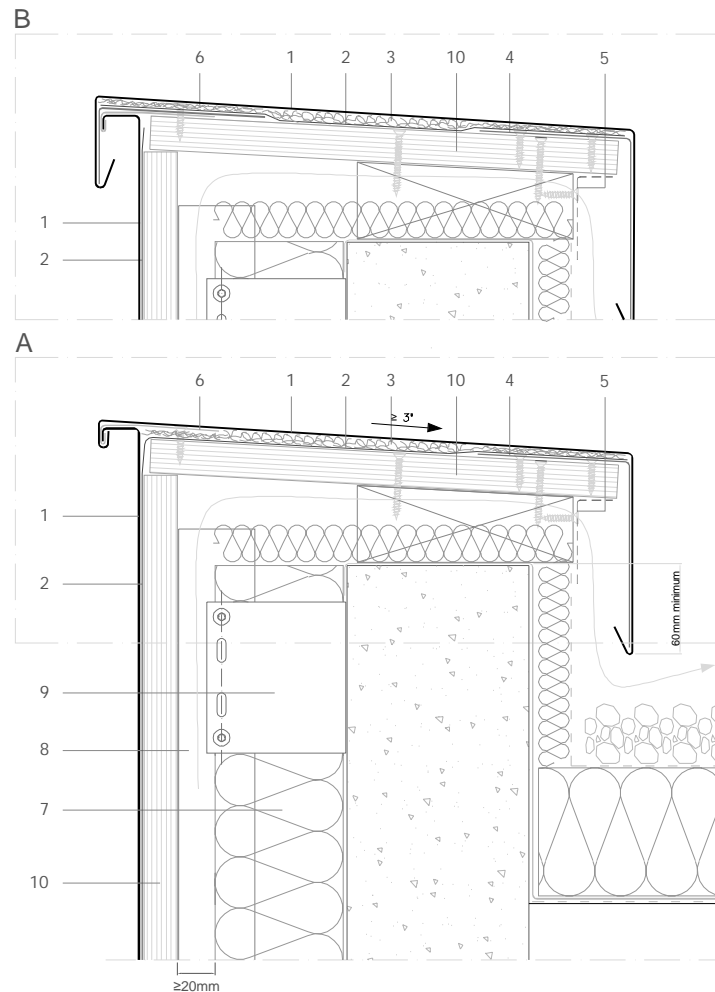

All dimensions are indicative unless specified on the drawing
Sheet thickness may be exaggerated for clarity

Scale 1/5

Notes:

- 'A' shows the wall capping folded around the top angle seam of the cladding, giving a very fine cladding head detail.
- 'B' shows the wall capping folded around a continuous fixing strip to increase the vertical face of the capping to tie in visually with other cladding elements if desired.
- Generic structural details are given for indicative purposes only.

1. elZinc® cladding
2. Membrane
3. Structural underlay
4. Folded galvanised steel profiles
5. elZinc® perforated sheet
6. elZinc® retention profile
7. Insulation
8. Wooden batten
9. Wall bracket
10. Substrate