

ASS V 1.1.02 Angle seam 25mm and cross joints.

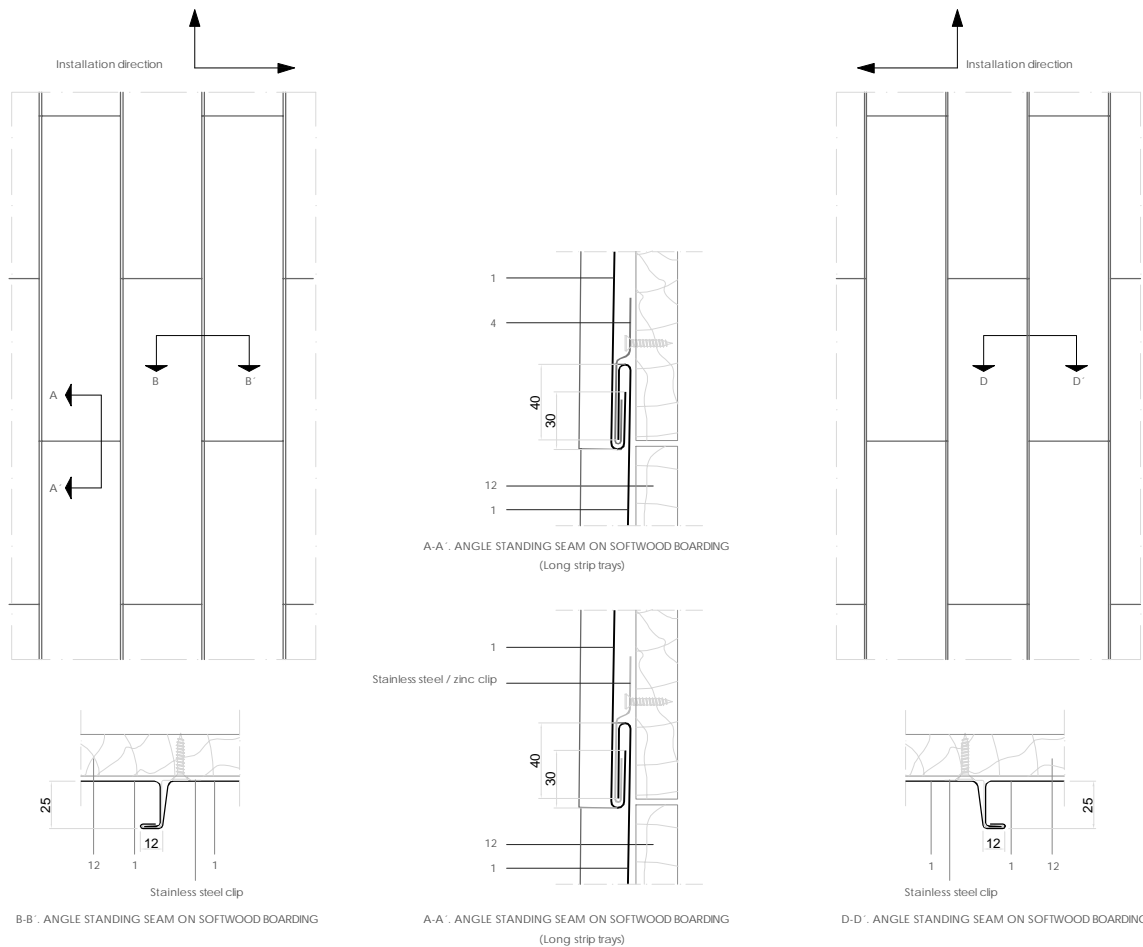

All dimensions are indicative unless specified on the drawing
Sheet thickness may be exaggerated for clarity

Scale 1/4

Notes:

- Typical profiled tray dimensions are shown. These can change slightly according to profiling machine manufacturer.
- Fixed stainless steel clips are shown. Trays over 1.5m use sliding clips as well as fixed clips.
- For long strip cladding, a folded galvanised retention profile (fixing strip) is used along the whole width of the top fold of the tray to hold it securely in place.
- The elevation shows a staggered design. See our sales literature for more design possibilities.

1. elZinc® cladding
2. Membrane
3. Structural underlay
4. Folded galvanised steel profiles
5. elZinc® perforated sheet
6. elZinc® retention profile
7. Insulation
8. Wooden batten
9. Wall bracket
10. Substrate

ASS V 1.1.02 Angle seam 25mm and cross joints.

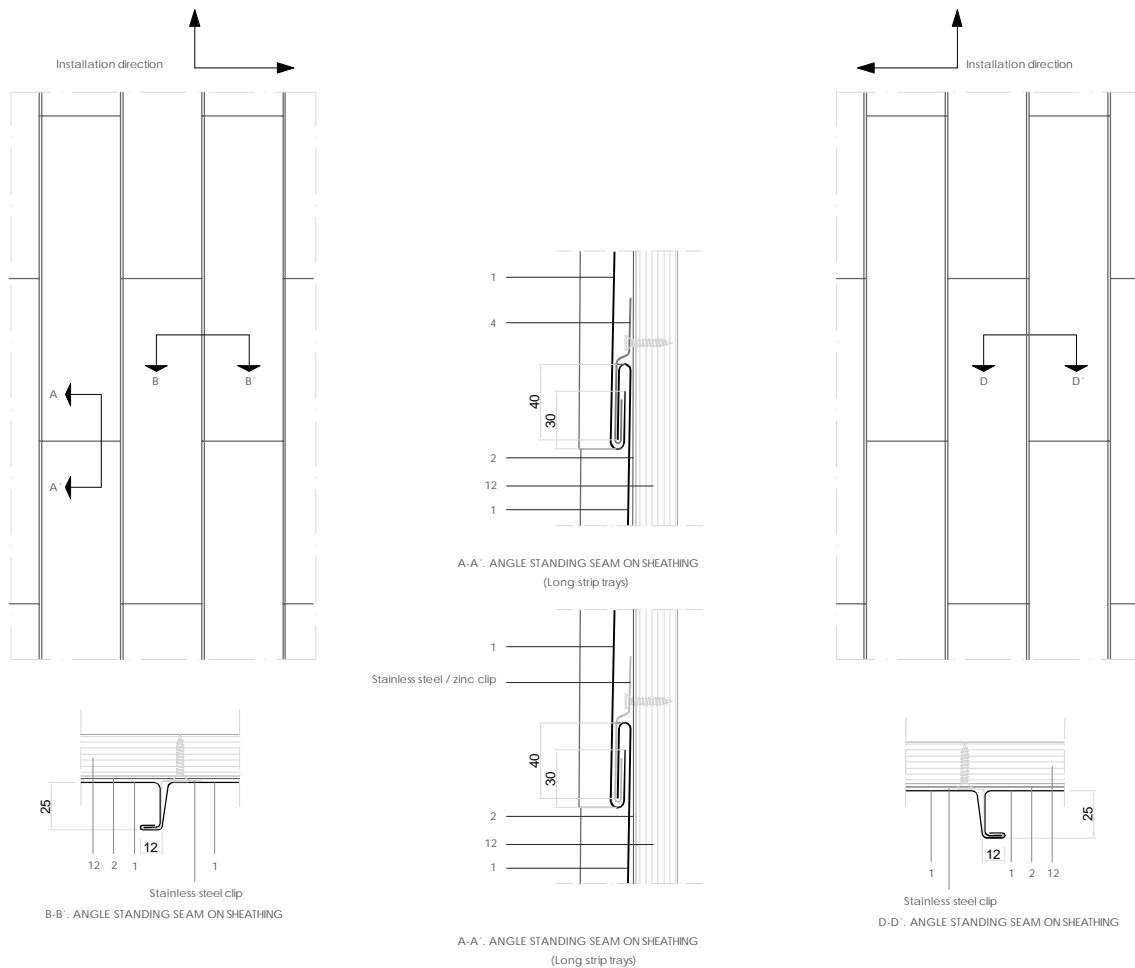

All dimensions are indicative unless specified on the drawing
Sheet thickness may be exaggerated for clarity

Scale 1/4

Notes:

- Typical profiled tray dimensions are shown. These can change slightly according to profiling machine manufacturer.
- Fixed stainless steel clips are shown. Trays over 1.5m use sliding clips as well as fixed clips.
- For long strip cladding, a folded galvanised retention profile (fixing strip) is used along the whole width of the top fold of the tray to hold it securely in place.
- The elevation shows a staggered design. See our sales literature for more design possibilities.

1. elZinc® cladding
2. Membrane
3. Structural underlay
4. Folded galvanised steel profiles
5. elZinc® perforated sheet
6. elZinc® retention profile
7. Insulation
8. Wooden batten
9. Wall bracket
10. Substrate