

ASS V 4.1.03 Front vented capping - rear downstand.

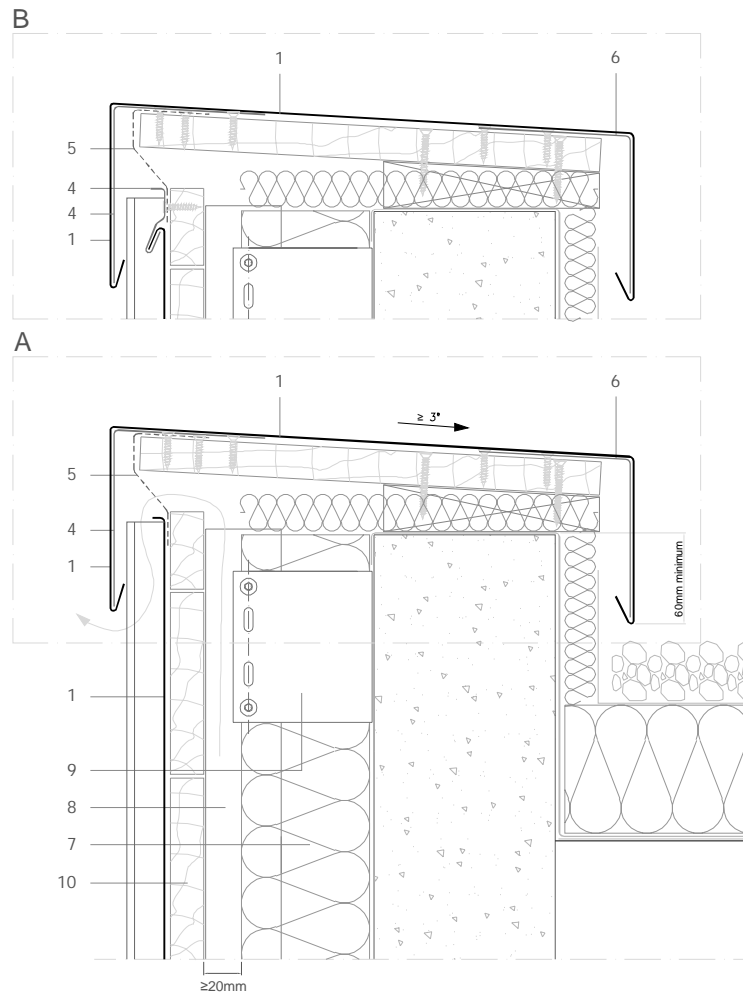

All dimensions are indicative unless specified on the drawing
Sheet thickness may be exaggerated for clarity

Scale 1/5

Notes:

- 'A' shows the top return fold for traditional 'sheet' cladding.
- 'B' shows the top return fold for long strip cladding.
- In the absence of local or national regulations, it is recommended that the coping overlap the cladding by a minimum of 60mm.
- Generic structural details are given for indicative purposes only.

1. elZinc® cladding
2. Membrane
3. Structural underlay
4. Folded galvanised steel profiles
5. elZinc® perforated sheet
6. elZinc® retention profile
7. Insulation
8. Wooden batten
9. Wall bracket
10. Substrate

ASS V 4.1.03 Front vented capping - rear downstand.

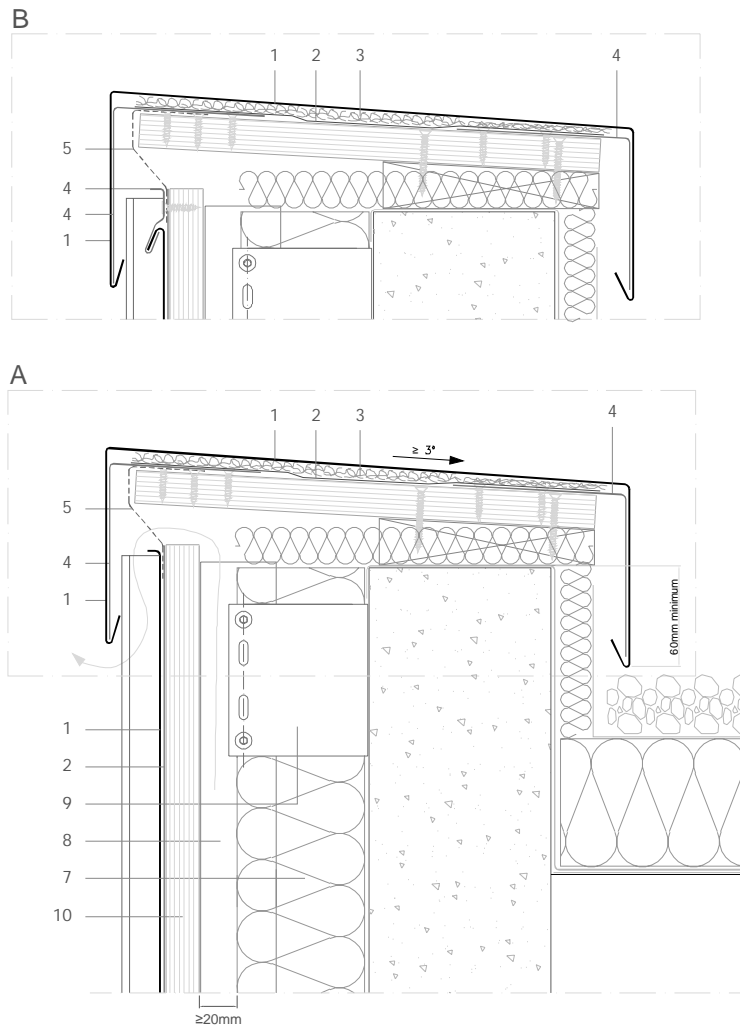

All dimensions are indicative unless specified on the drawing
Sheet thickness may be exaggerated for clarity

Scale 1/5

Notes:

- 'A' shows the top return fold for traditional 'sheet' cladding.
- 'B' shows the top return fold for long strip cladding.
- In the absence of local or national regulations, it is recommended that the coping overlap the cladding by a minimum of 60mm.
- Generic structural details are given for indicative purposes only.

1. elZinc® cladding
2. Membrane
3. Structural underlay
4. Folded galvanised steel profiles
5. elZinc® perforated sheet
6. elZinc® retention profile
7. Insulation
8. Wooden batten
9. Wall bracket
10. Substrate