

Traditional systems - Diamond Tile

T D 1.1.02 Diamond tile joints.

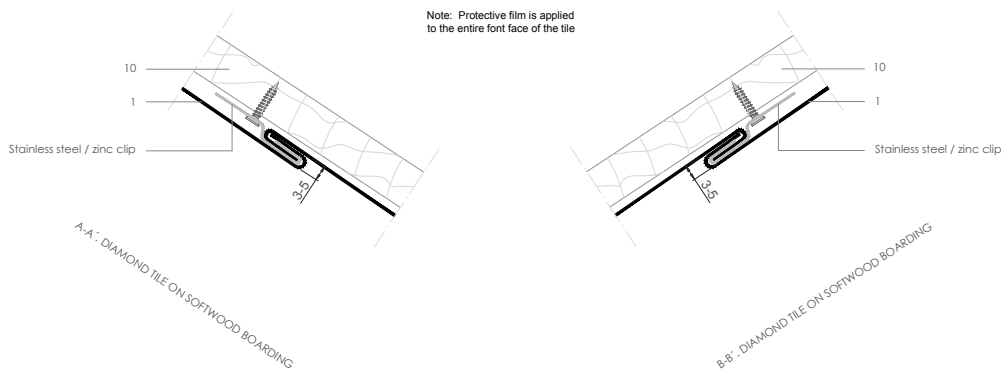
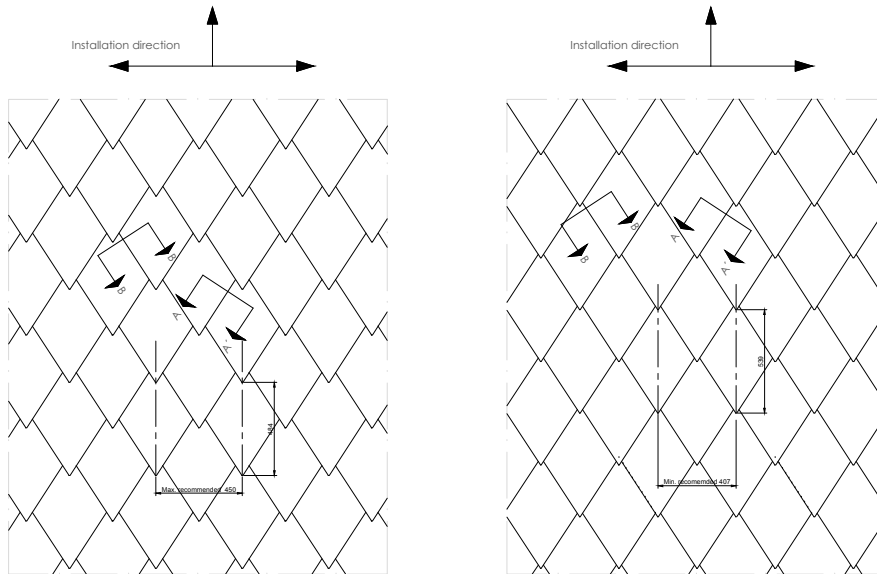

Scale 1/4

All dimensions are indicative unless specified on the drawing
Sheet thickness may be exaggerated for clarity

Notes:

- Tiles are direct fixed to the fully supporting substrate.
- They interlock along each edge with one another to provide a weather-tight cladding.

1. elZinc® cladding
2. Membrane
3. Structural underlay
4. Folded galvanised steel profiles
5. elZinc® perforated sheet
6. elZinc® retention profile
7. Insulation
8. Wooden batten
9. Wall bracket
10. Substrate
11. elZinc® Diamond Tile

Traditional systems - Diamond Tile

T D 1.1.02 Diamond tile joints.

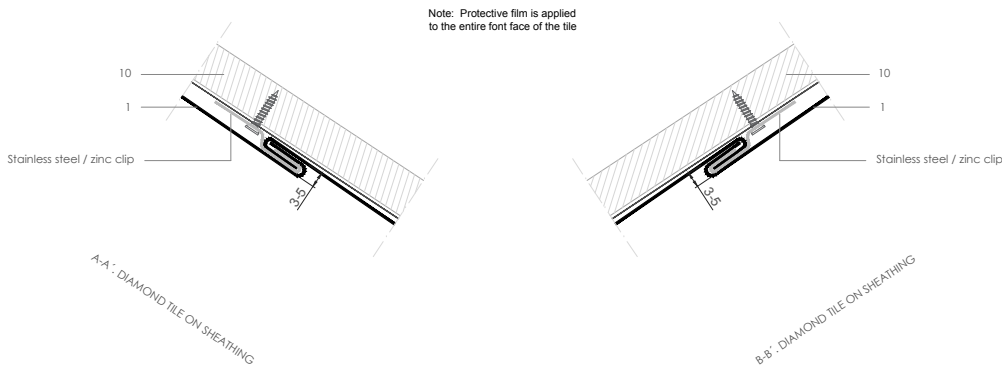
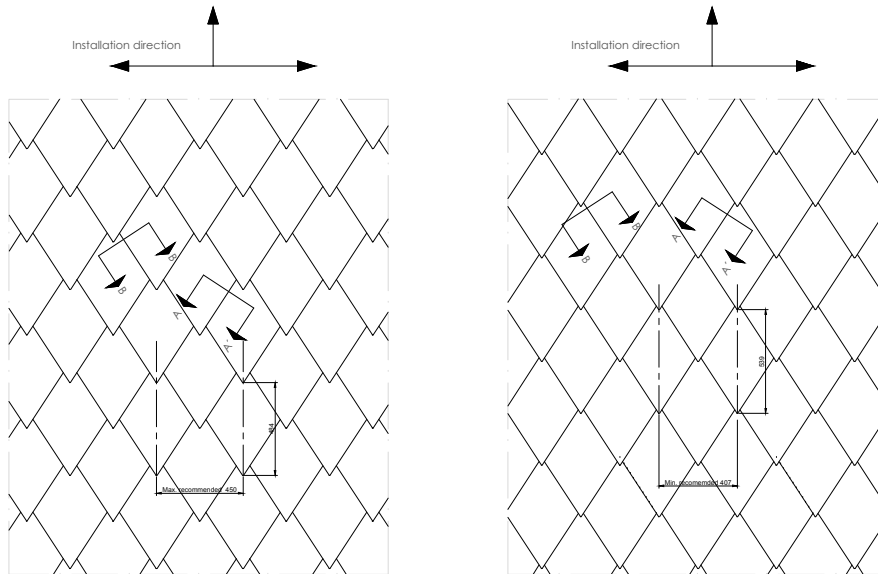

Scale 1/4

All dimensions are indicative unless specified on the drawing
Sheet thickness may be exaggerated for clarity

Notes:

- Tiles are direct fixed to the fully supporting substrate.
- They interlock along each edge with one another to provide a weather-tight cladding.

1. elZinc® cladding
2. Membrane
3. Structural underlay
4. Folded galvanised steel profiles
5. elZinc® perforated sheet
6. elZinc® retention profile
7. Insulation
8. Wooden batten
9. Wall bracket
10. Substrate
11. elZinc® Diamond Tile