

DLSS 11.1.01 Soldered chimney, section.

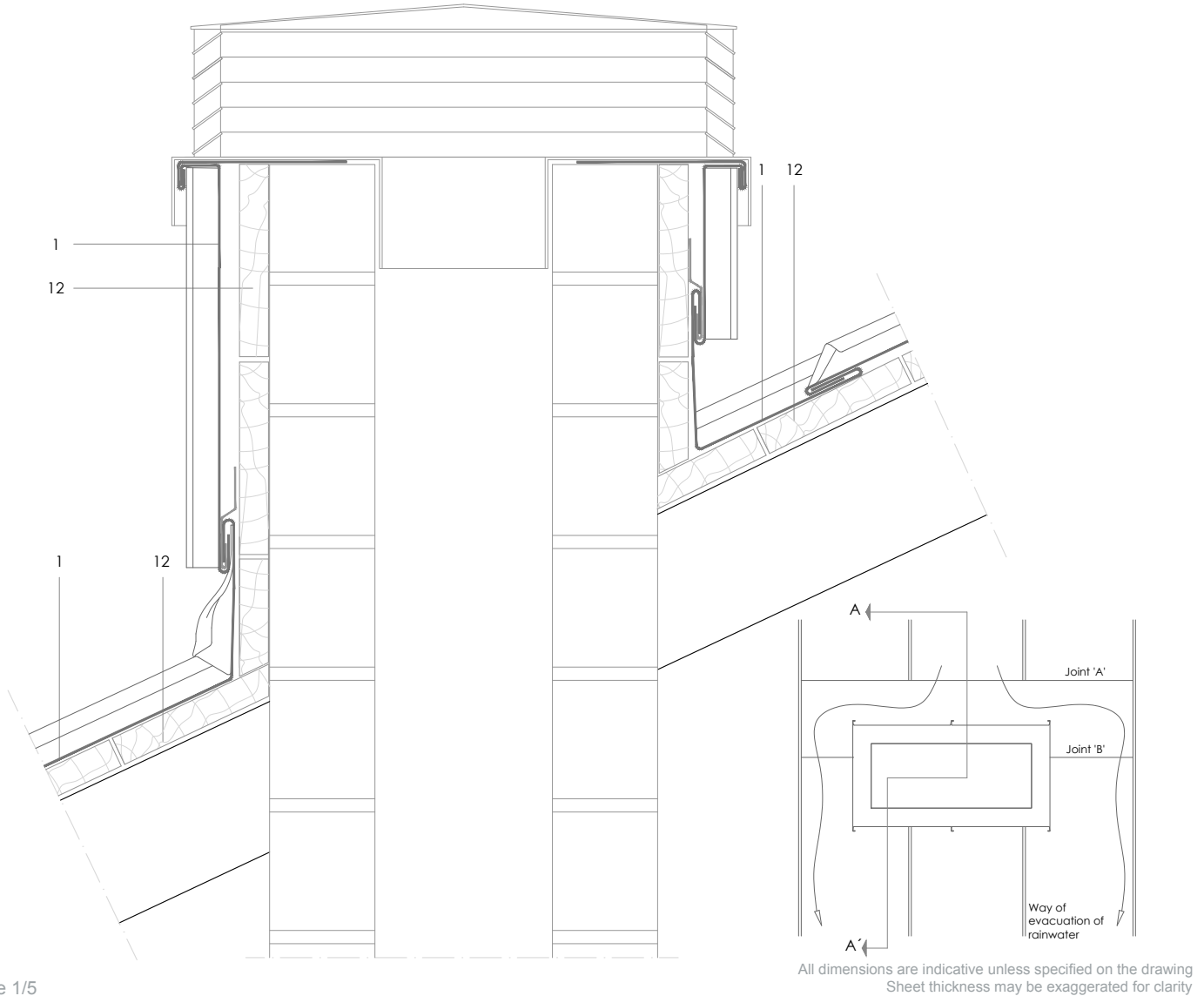

Scale 1/5

All dimensions are indicative unless specified on the drawing  
Sheet thickness may be exaggerated for clarity

Notes:

- Joint 'A': Pitch > 25° - single lock cross welt (see DLSS 2.2.01)  
25° ≥ pitch > 10° - Lap lock joint (see DLSS 2.2.02)  
10° ≥ pitch - double lock standing seam turned down at tray edges and welted up into longitudinal standing seams, sealed.
- Laplock joint 'B': see DLSS 2.2.01.
- For chimneys wider than two bays it is recommended to incorporate a cricket in the back gutter to channel rainwater around the chimney.
- See DLSS 11.2.01b y 11.2.02b for greater detail of the chimney cladding.
- See DLSS 11.2.01a y 11.2.02a for greater detail of the roofing sheet upstands.
- Use elZinc® fluxes and strippers when preparing the material for soldering.
- Generic structural details are shown for illustrative purposes only.

1. elZinc® cladding
2. Membrane
3. Structural underlay
4. Folded galvanised steel profiles
5. elZinc® perforated sheet
6. elZinc® retention profile
7. Insulation
8. elZinc® hung gutter
9. Gutter clip
10. Gutter bracket
11. elZinc® clip
12. Substrate

DLSS 11.1.01 Soldered chimney, section.

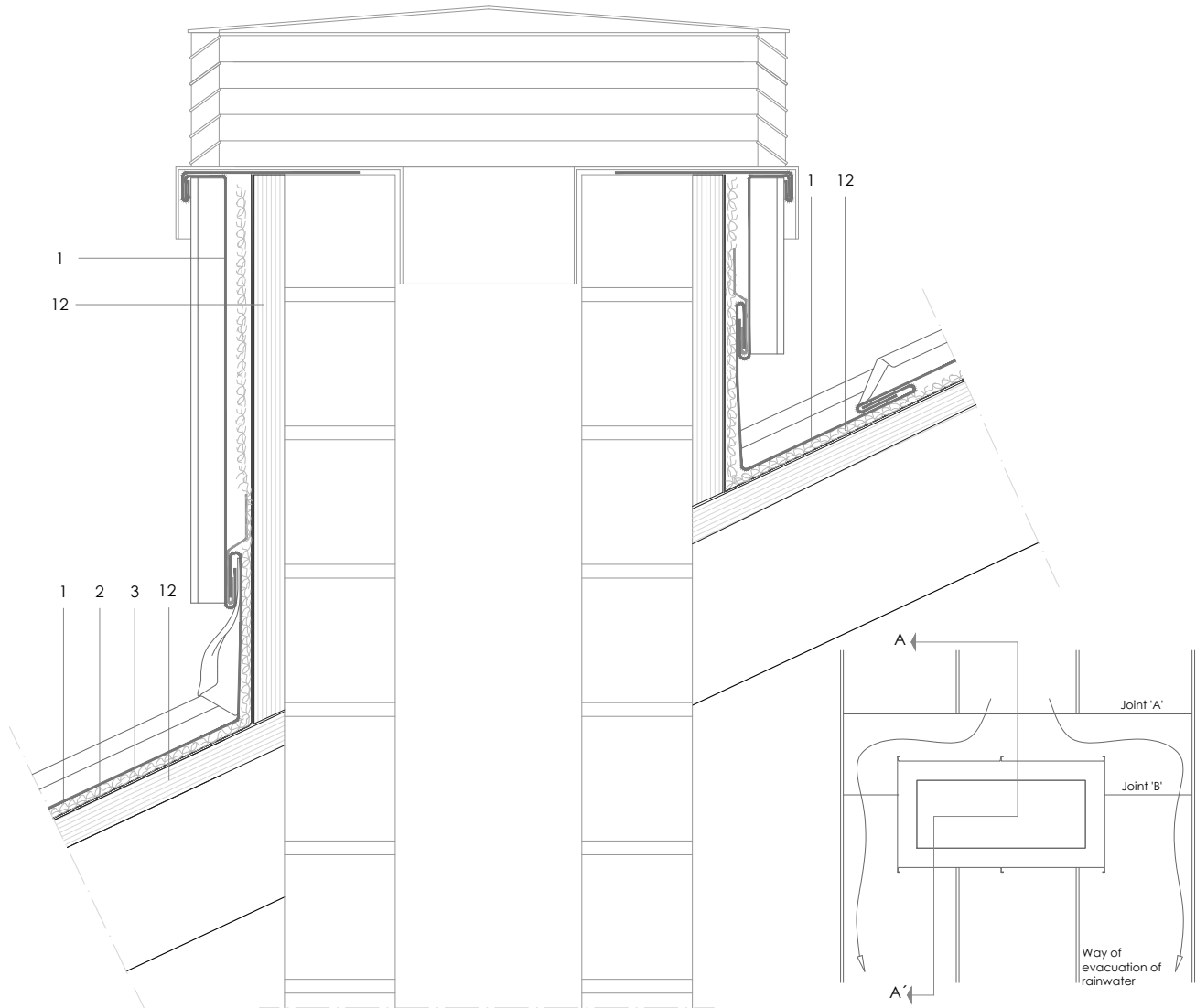

Scale 1/5

All dimensions are indicative unless specified on the drawing  
Sheet thickness may be exaggerated for clarity

Notes:

- Joint 'A': Pitch > 25° - single lock cross welt (see DLSS 2.2.01)  
25° ≥ pitch > 10° - Lap lock joint (see DLSS 2.2.02)  
10° ≥ pitch - double lock standing seam turned down at tray edges and welted up into longitudinal standing seams, sealed.
- Laplock joint 'B': see DLSS 2.2.01.
- For chimneys wider than two bays it is recommended to incorporate a cricket in the back gutter to channel rainwater around the chimney.
- See DLSS 11.2.01b y 11.2.02b for greater detail of the chimney cladding.
- See DLSS 11.2.01a y 11.2.02a for greater detail of the roofing sheet upstands.
- Use elZinc® fluxes and strippers when preparing the material for soldering.
- Generic structural details are shown for illustrative purposes only.

1. elZinc® cladding
2. Membrane
3. Structural underlay
4. Folded galvanised steel profiles
5. elZinc® perforated sheet
6. elZinc® retention profile
7. Insulation
8. elZinc® hung gutter
9. Gutter clip
10. Gutter bracket
11. elZinc® clip
12. Substrate