

DLSS 11.1.02 Welled chimney, section.

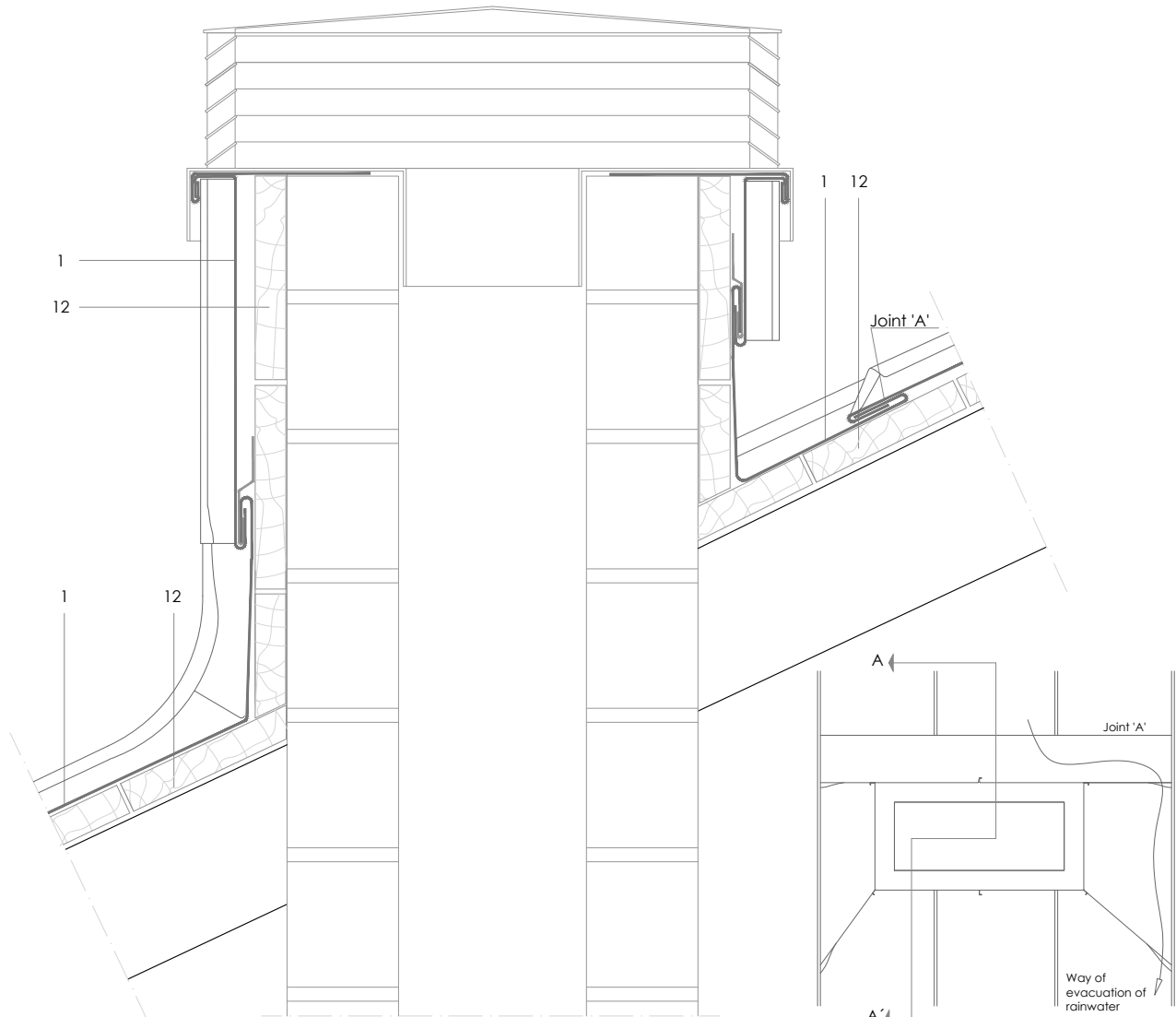

All dimensions are indicative unless specified on the drawing
Sheet thickness may be exaggerated for clarity

Scale 1/5

Notes:

- This advanced technique eliminates soldered joints around a chimney.
- It requires a high degree of craftsmanship to execute correctly. The turned down areas of the standing seams are sealed with a closed cell foam strip for example.
- Joint 'A': Pitch > 25° - single lock cross welt (see DLSS 2.2.01)
25° ≥ pitch > 10° - Lap lock joint (see DLSS 2.2.02)
10° ≥ pitch - double lock standing seam turned down at tray edges and welted up into longitudinal standing seams, sealed.
- For chimneys wider than two bays it is recommended to incorporate a cricket in the back gutter to channel rainwater around the chimney.
- See DLSS 11.3.01a y 11.3.01b and 11.3.01c for greater detail.
- Generic structural details are shown for illustrative purposes only.

1. elZinc® cladding
2. Membrane
3. Structural underlay
4. Folded galvanised steel profiles
5. elZinc® perforated sheet
6. elZinc® retention profile
7. Insulation
8. elZinc® hung gutter
9. Gutter clip
10. Gutter bracket
11. elZinc® clip
12. Substrate

DLSS 11.1.02 Welled chimney, section.

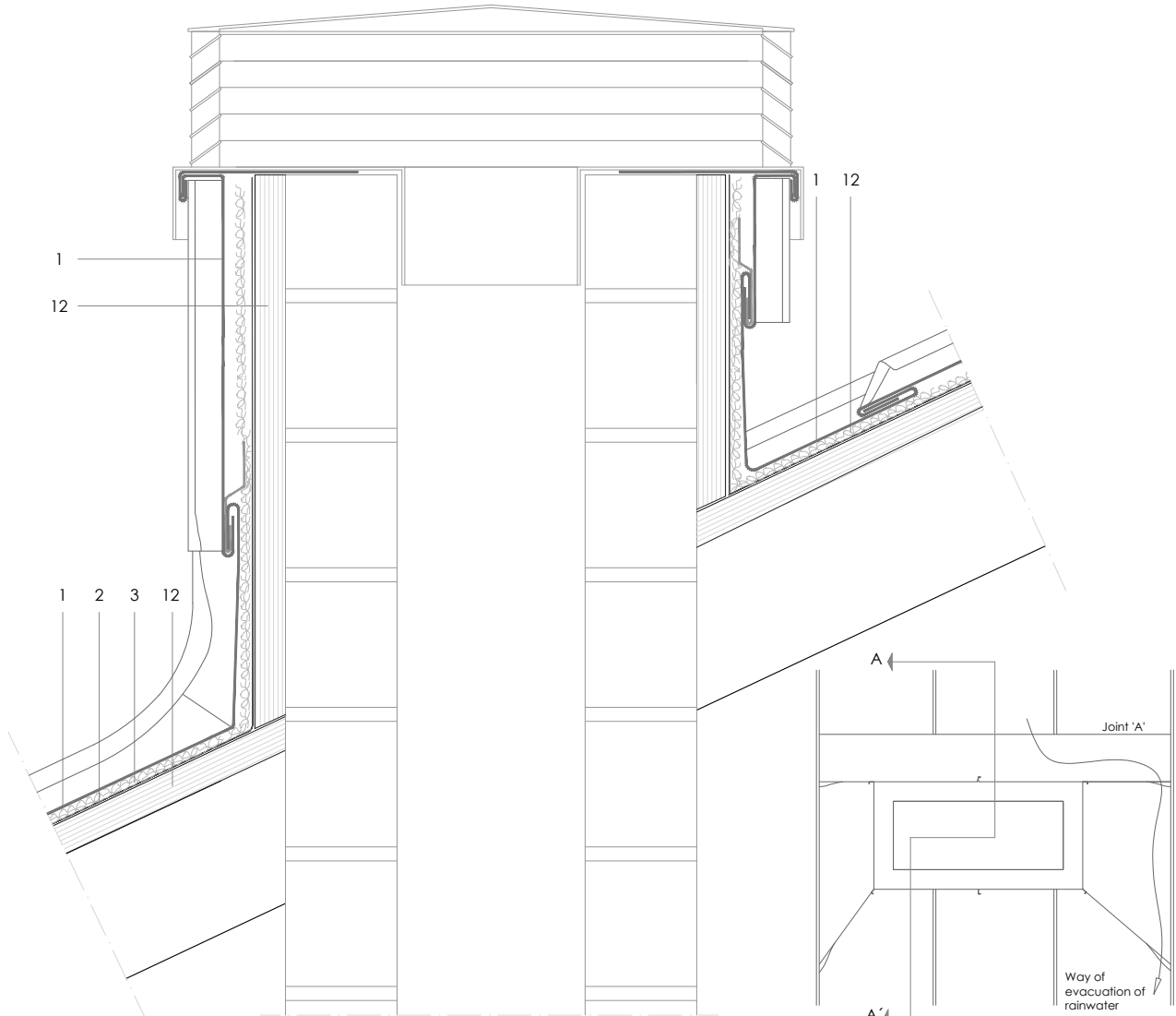

Scale 1/5

All dimensions are indicative unless specified on the drawing
Sheet thickness may be exaggerated for clarity

Notes:

- This advanced technique eliminates soldered joints around a chimney.
- It requires a high degree of craftsmanship to execute correctly. The turned down areas of the standing seams are sealed with a closed cell foam strip for example.
- Joint 'A': Pitch > 25° - single lock cross welt (see DLSS 2.2.01)
25° ≥ pitch > 10° - Lap lock joint (see DLSS 2.2.02)
10° ≥ pitch - double lock standing seam turned down at tray edges and welled up into longitudinal standing seams, sealed.
- For chimneys wider than two bays it is recommended to incorporate a cricket in the back gutter to channel rainwater around the chimney.
- See DLSS 11.3.01a y 11.3.01b and 11.3.01c for greater detail.
- Generic structural details are shown for illustrative purposes only.

1. elZinc® cladding
2. Membrane
3. Structural underlay
4. Folded galvanised steel profiles
5. elZinc® perforated sheet
6. elZinc® retention profile
7. Insulation
8. elZinc® hung gutter
9. Gutter clip
10. Gutter bracket
11. elZinc® clip
12. Substrate