

DLSS 2.4.01 Step (using pinched seam).

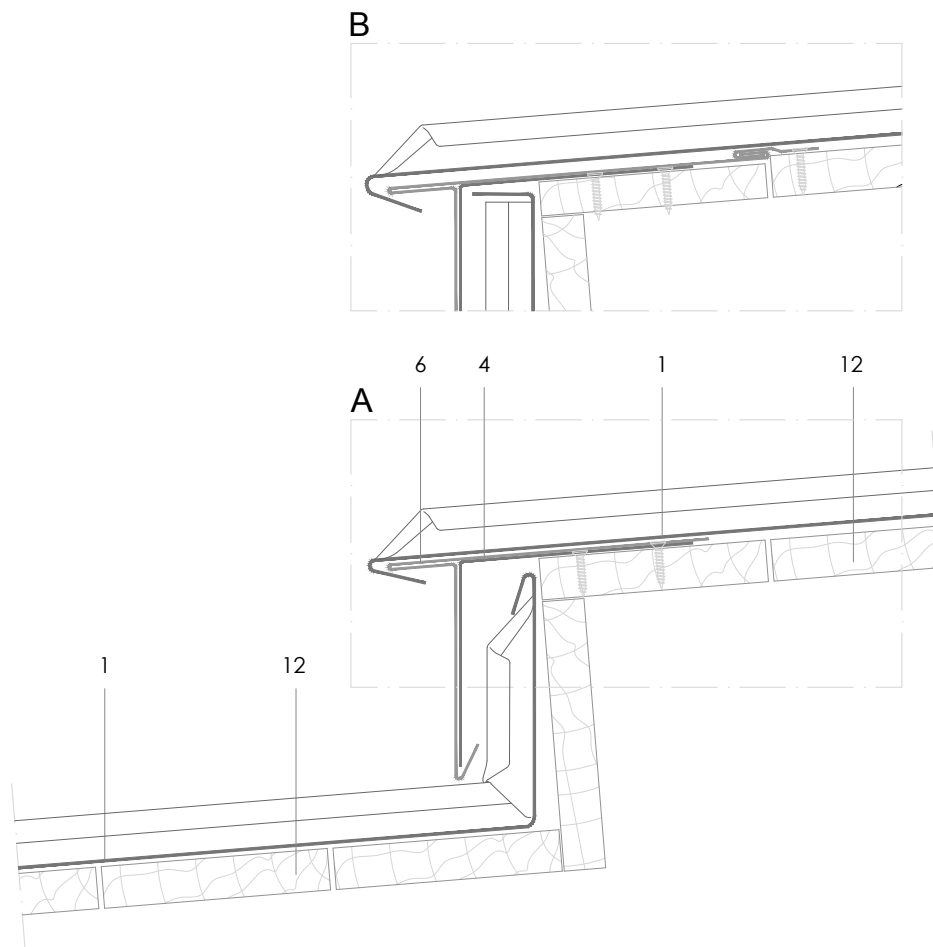

All dimensions are indicative unless specified on the drawing
Sheet thickness may be exaggerated for clarity

Scale 1/4

Notes:

- Used as an expansion joint.
- Minimum recommended pitch: 3°.
- 'A' shows top of seam upstand closed for extra weatherability and is recommended for very exposed roofs.
- 'B' shows typical detail.
- 'A' and 'B' both show pinched seam upstand detail (DLSS 1.2.2.03a).
- Alternative upstand detail: Pinched seam with saddle capping (DLSS 1.2.2.03b).

1. elZinc® cladding
2. Membrane
3. Structural underlay
4. Folded galvanised steel profiles
5. elZinc® perforated sheet
6. elZinc® retention profile
7. Insulation
8. elZinc® hung gutter
9. Gutter clip
10. Gutter bracket
11. elZinc® clip
12. Substrate

DLSS 2.4.01 Step (using pinched seam).

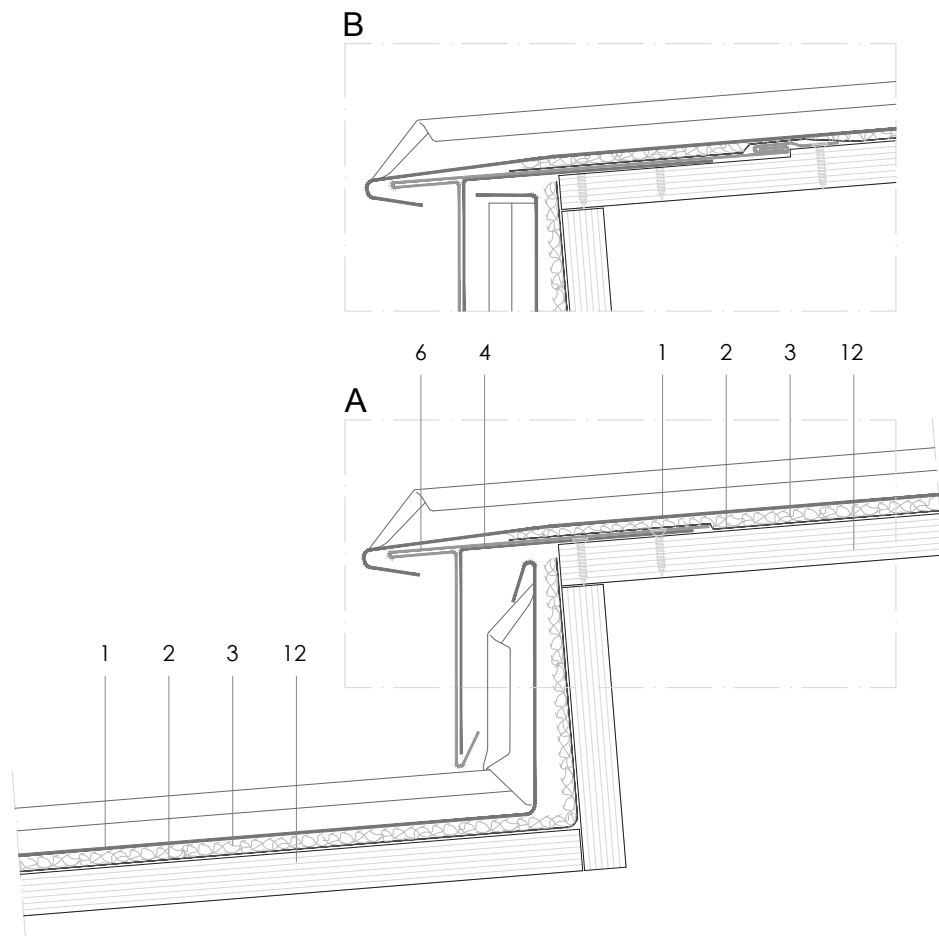

All dimensions are indicative unless specified on the drawing
Sheet thickness may be exaggerated for clarity

Scale 1/4

Notes:

- Used as an expansion joint.
- Minimum recommended pitch: 3°.
- 'A' shows top of seam upstand closed for extra weatherability and is recommended for very exposed roofs.
- 'B' shows typical detail.
- 'A' and 'B' both show pinched seam upstand detail (DLSS 1.2.2.03a).
- Alternative upstand detail: Pinched seam with saddle capping (DLSS 1.2.2.03b).

1. elZinc® cladding
2. Membrane
3. Structural underlay
4. Folded galvanised steel profiles
5. elZinc® perforated sheet
6. elZinc® retention profile
7. Insulation
8. elZinc® hung gutter
9. Gutter clip
10. Gutter bracket
11. elZinc® clip
12. Substrate