

DLSS 1.1.01 Standing seam.

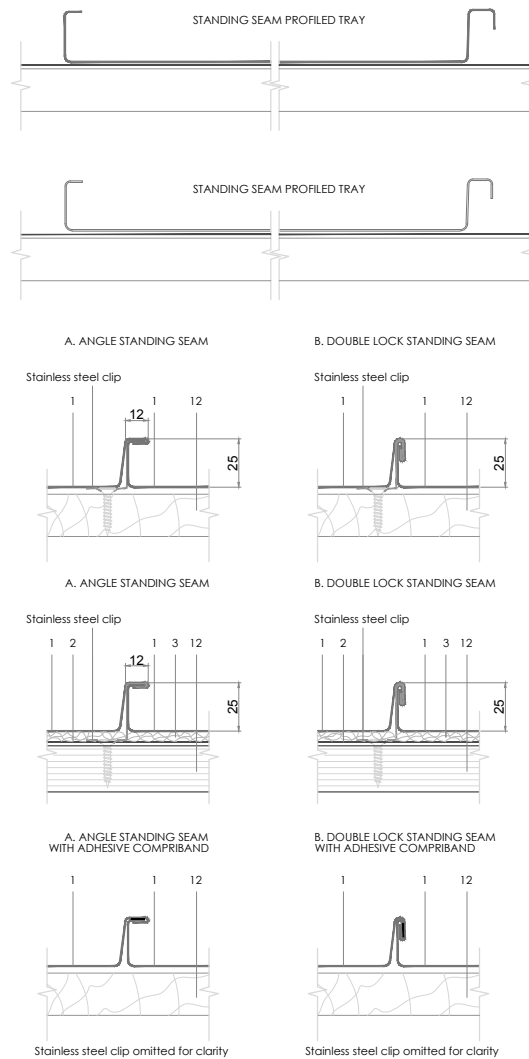

All dimensions are indicative unless specified on the drawing
Sheet thickness may be exaggerated for clarity

Scale 1/4

Notes:

- Annular ring-shank nails can be used instead of screws to fix clips.
- Angle standing seam is used principally for façades and steeply pitched roofs.
- Compriband sealing is generally advised below 3° of pitch.
- Stainless steel fixed clips are shown. Sliding clips are used together with fixed clips for tray lengths greater than 1.5m.

1. elZinc® cladding
2. Membrane
3. Structural underlay
4. Folded galvanized steel profiles
5. elZinc® perforated sheet
6. elZinc® retention profile
7. Insulation
8. elZinc® hung gutter
9. Gutter clip
10. Gutter bracket
11. elZinc® clip
12. Substrate