

DLSS FG 12.2.01 Skylight, sections.

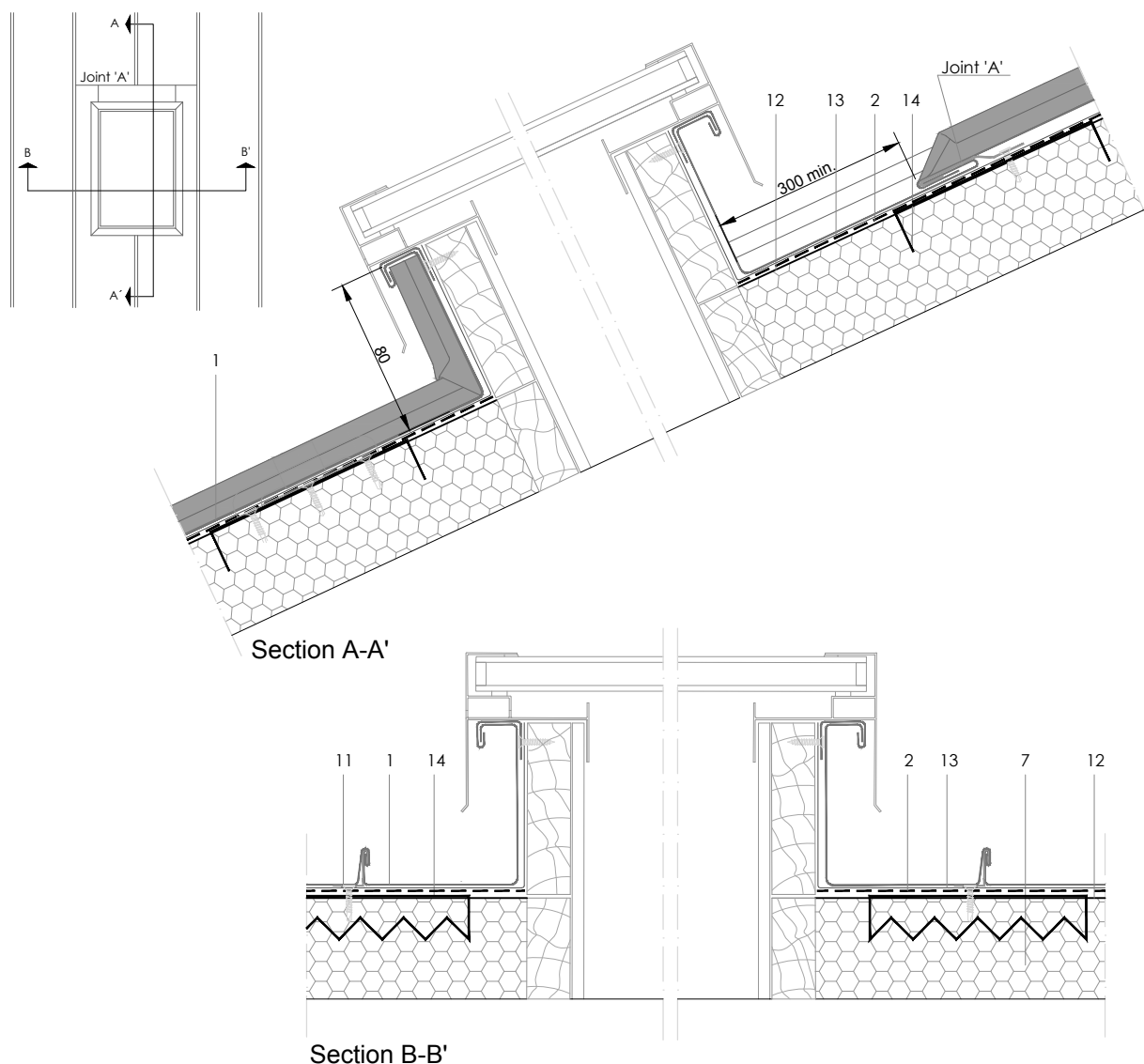

Scale 1/5

All dimensions are indicative unless specified on the drawing
Sheet thickness may be exaggerated for clarity

Notes:

- For skylights wider than two bays it is recommended to incorporate a cricket in the back gutter to channel rainwater around the skylight.
- Generic details of the window frame and structure are shown for illustrative purposes only.

- elZinc® cladding Protect+
- Roofing membrane
- Structural underlay
- Folded galvanised steel profiles
- elZinc® perforated sheet
- elZinc® retention profile
- Celular glass insulation
- elZinc® hung gutter
- Gutter clip
- Gutter bracket
- elZinc® clip
- Hot applied bitumen
- Separating membrane
- Fixing plate in galvanised