

DLSS RI 2.2.03 Lap lock joint - continuous seam.

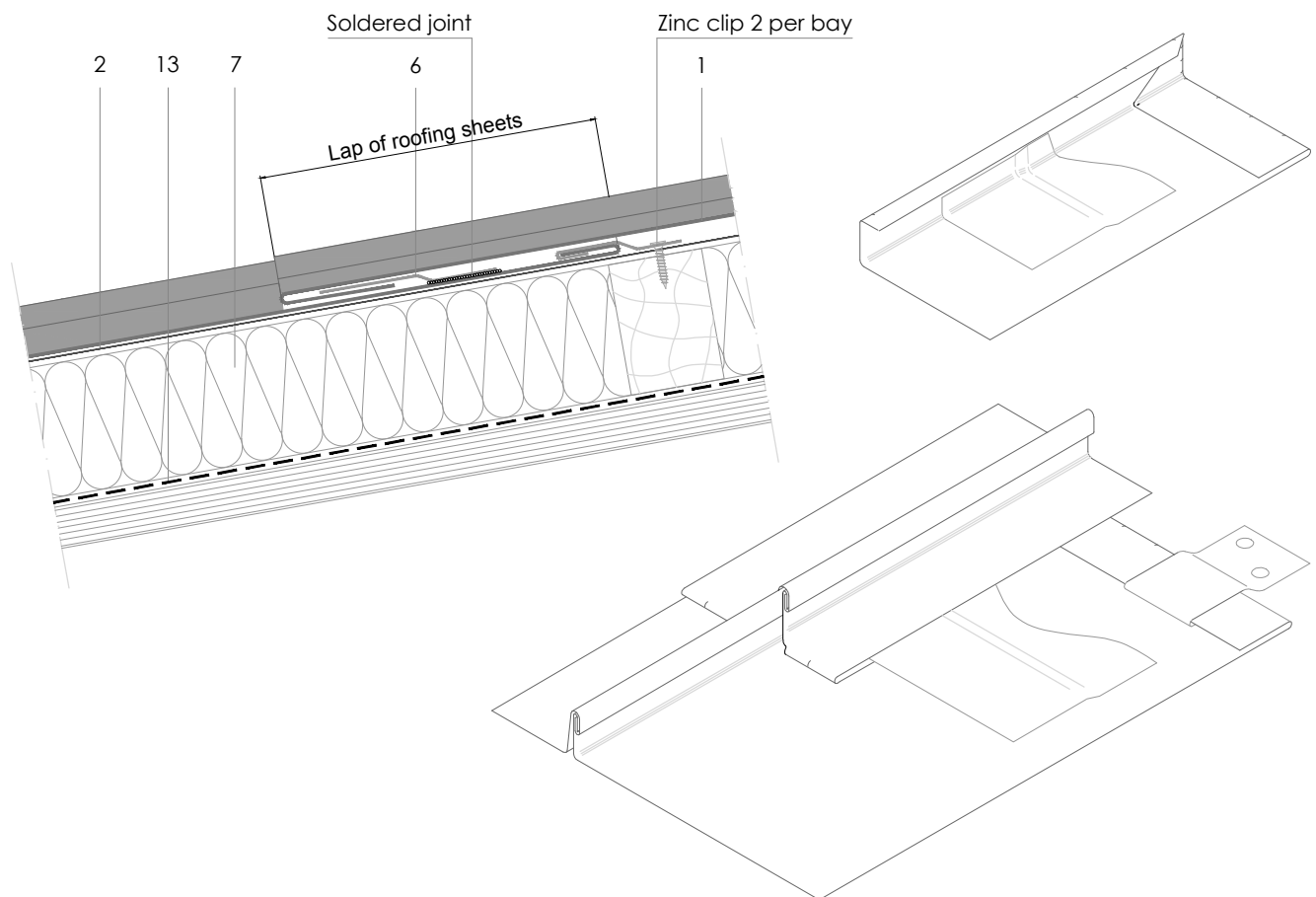

Scale 1/4

All dimensions are indicative unless specified on the drawing
Sheet thickness may be exaggerated for clarity

Notes:

- Used as an expansion joint.
- Minimum recommended pitch: 10°.
- Lap of sheets according to local or national regulations. In their absence, a minimum of 180mm is recommended.

1. elZinc® cladding Protect+
2. Separating membrane
3. Structural underlay
4. Folded galvanised steel profiles
5. elZinc® perforated sheet
6. elZinc® retention profile
7. Rigid insulation
8. elZinc® hung gutter
9. Gutter clip
10. Gutter bracket
11. elZinc® clip
12. Substrate (Ply or Metal Deck)
13. High performance vapour barrier
14. Rigid insulation fixing clip